



Pensacola State College
**YOUR COMMUNITY
YOUR LEGACY**

PENSACOLA STATE COLLEGE

JAN MILLER CONFERENCE CENTER — PROGRESS TOWARD EXCELLENCE

There is no space available that meets College or community conference or training needs if a groups exceeds 300 individuals for banquet or ballroom type events. The Jean & Paul Amos Studio can host 600 attendees but 499 of the seats available are stadium style seats that are not conducive to larger training meetings or conferences. Additionally, moving the sound and lighting equipment costs approximately \$1,250 for each event. Routinely, requests from community partners must be declined because of the lack of available open dates.

"When you have a multitude of blessings, you have a social responsibility to the community in which you live."
-Jan Miller, donor and volunteer

YOU CAN HELP

A dedicated conference center would enable the College to enhance professional development training opportunities for College faculty and staff. Additionally, students and community partners would benefit from the facility that could be used to meet the training, workshop and conference needs detailed below:



- Master teacher seminars
- Nonprofit Center Workshops, Summit, Trainings
- Opportunities for Hospitality and Culinary Students to engage in hands on experiences
- Internships and Mentorships, in-house
- Guest Lecturers to share expertise and improve student experience
- Scholarship and Entrepreneurial Events to promote student success
- Reduced event expenses with improved opportunities and availability
- Volunteer and Career Fairs to invite community involvement

THE NEED:

Currently the available spaces on campus have limited seating and do not meet the training, conferencing and event needs of the College.

- WSRE Jean & Paul Amos Performance Studio- \$1,250 cost per use
 - 100 banquet style attendee space & 499 stadium seats
- Delaino Student Center- limited availability with negative impacts on student socialization and networking
 - Capacity is limited to 250 for plated dinners and entertainment
- Culinary Dining Room-limited access due to culinary and hospitality instructional courses
 - Capacity is limited to 60 patrons
- The closure of frequently used community venues like New World Landing adds burdens to community partners seeking a conference venue

Naming Opportunities

Significant gifts to the college provide opportunities for donors to designate the name of a college facility or program in honor of the donor or another person. Scholarships, endowed chairs, lecture series, and faculty and staff awards programs are among the named gift opportunities, as are buildings or portions of buildings, including laboratories and conference rooms. Naming opportunities are offered in recognition of a single, tax-deductible, irrevocable gift or written pledge made over a specified period of time.

PENSACOLA CAMPUS	
Janice Miller Conference Center	NAMED
Meeting Room A	\$150,000
Meeting Room B	\$100,000
Meeting Room C	\$100,000
Stage	\$50,000
Breakout Room	\$50,000
Lobby and Vestibule	\$50,000
Catering/Kitchen Area	\$25,000
Small Meeting Room	\$15,000
Office/Ticket Sales	\$10,000
Donor Wall Listing	\$500-\$5,000



“There are many special events, seminars and workshops in the course of the academic year held at the campus by both the College and the community, yet we do not have a dedicated space for these events. We also have to decline requests or go off campus for our own events because the space we have is not large enough to accommodate special events. This facility would ensure that we do not inconvenience the regular activities of the campus when special events are requested.”

Dr. Ed Meadows, President, Pensacola State College



Pensacola State College
YOUR COMMUNITY
YOUR LEGACY

Room Usages and Capacities

Room	Mix & Mingle	Banquet	Classroom with Tables	Floor Row Seating	Career/Vendor Fair
Foyer	50-60	X	X	X	4-6
Ballroom	500-600	280-360	150-180	450-550	30-40
Meeting Room A	300-350	120-175	75-125	250-300	15-20
Meeting Room B	150-175	48-64	40-75	125-150	8-10
Meeting Room C	150-175	48-64	40-75	125-150	8-10
Breakout Room	25-30	10-12	10-12	X	X

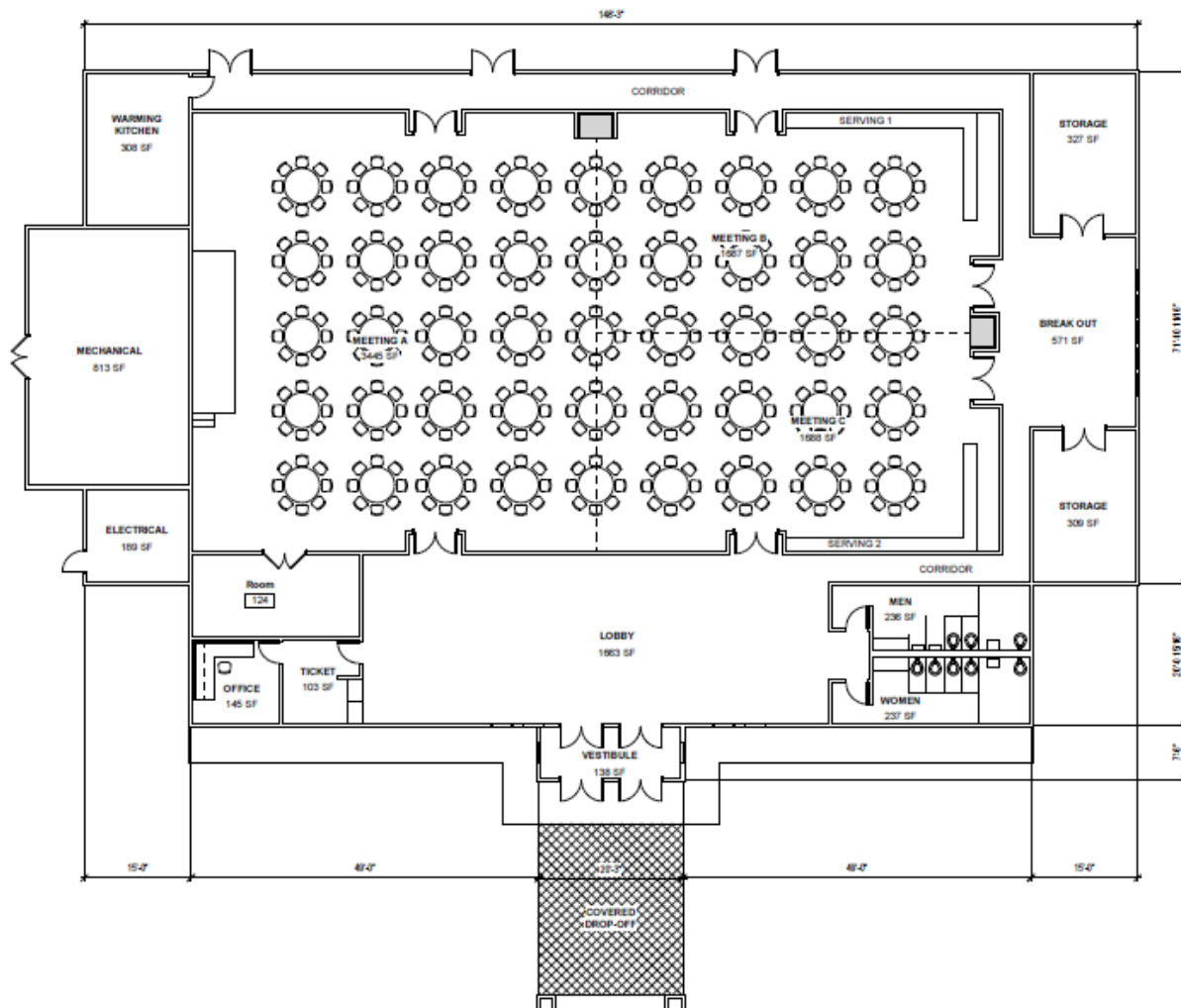



Recognition
Art



Pensacola State College
**YOUR COMMUNITY
YOUR LEGACY**

Donor Letter of Intent

In support of the Your Community, Your Legacy Campaign to benefit Pensacola State College, I (we)
intend to pledge (_____) over (____) years in the form of (____).
(Gifts may be pledged over a 3-to-5-year period) (Payment method: Cash, securities, etc.)

Please accept my initial gift of \$_____, with the remainder to be paid as follows:

Number of Payments (____) Paid: ☐ Annually ☐ Quarterly ☐ Monthly (Bill Me on Day: (10th, etc.____))

I choose to support the following area of Pensacola State College's Comprehensive Campaign:

- ☐ Workforce Development ☐ Scholarships ☐ Conference Center ☐ Fund for Excellence

Please check all that apply:

- ☐ I (we) would like a representative from Pensacola State College to call me about a naming opportunity.
☐ I intend to assist Pensacola State College in securing matching funds from my employer.
☐ I would like a representative from Pensacola State College to call me about a legacy gift.

For purposes of donor recognition:

- ☐ I (we) desire that our pledge be treated as an anonymous commitment; or
☐ Please list my (our) name as specified below in all appropriate donor recognition:

Name: _____
(Please print above exactly as you would like your gift to be recognized. For example: John H. & Mary K. Jones, The Family of John Jones, In memory of Ms. Mary Johnson, John & Judy Galbraith, In honor of Jacob P. Keating. Donor wall listings limited to 35 characters.)

Name (Print): _____ PSC Graduation Yr: _____

Mailing Address: _____

City: _____ State: _____ Zip Code: _____

Office Phone: _____ Home/Cell Phone: _____

Email Address: _____ Fax: _____

Donor Signature: _____ Date: _____

Please make checks payable to and return this form to:

Pensacola State College Foundation
1000 College Boulevard, Building 17
Pensacola, FL 32504

(Please note **campaign** in the memo section)

Pensacola State College Foundation is a fully tax-exempt public charity under sections 501c3 of the Internal Revenue Code. Gifts to the Foundation are tax deductible to the extent allowed by law.

DONOR RECOGNITION WALL

Add Your Name to the Donor Recognition Wall! The Pensacola State College Conference Center donor recognition wall will recognize the friends, foundations, and many individuals and organizations who support the conference center with significant financial contributions. Gifts of any size are gratefully accepted, but donor wall recognition begins at the \$500 level.

Each category on the donor wall signifies a level of contribution. Donor recognition is ongoing and gifts may be made at any time. The donor recognition wall will continue to grow with each qualifying gift.

Legacy	\$100,000 and up	Listing as a Legacy Donor Name & 60 characters on donor wall cast bronze portrait plaque identifying named room
Visionary	\$50,000 - \$99,999	Donor Wall as Visionary Donor Name & 50 characters on donor wall cast bronze plaque identifying named room
Leader	\$25,000 - \$49,999	Donor Wall as a Leader Name & 45 characters on donor wall cast bronze plaque identifying named room
Sustainer	\$10,000 - \$24,999	Donor Wall as a Sustainer Name & 35 characters on donor wall cast bronze plaque identifying named room
Benefactor	\$5,000 - \$9,999	Donor Wall as a Benefactor Name and 35 characters on donor wall
Champion	\$2,500 - \$4,999	Donor Wall as a Champion Name and 35 characters on donor wall
Supporter	\$500 - \$2,499	Donor Wall as a Supporter Name on donor wall

Plaques may be inscribed with the names of individuals or organizations making the gift and may be made in honor or memory of a loved one. Please complete and submit this form with the Donor Letter of Intent that will serve as your pledge card. All donations are tax deductible. When we receive your pledge or check, we will send a form to detail the message on the donor wall and/or plaque.



Donor Recognition Wall Form

Please print your name in the blocks below, exactly as you would like for it to appear on the donor wall.

1	2	3	4	5	6	7	8	9	10
11	12	13	14	15	16	17	18	19	20
21	22	23	24	25	26	27	28	29	30
31	32	33	34	35	36	37	38	39	40
41	42	43	44	45	46	47	48	49	50
51	52	53	54	55	56	57	58	59	60

Please print carefully in the spaces below. Please note that blank spaces are part of your character count.

Please provide an email where we can send a copy of your plaque text for you to proof.

Email: _____

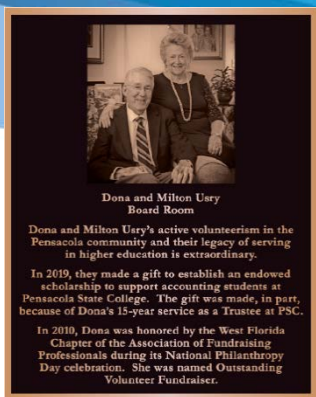

Legacy Donor Bronze Portrait Plaque Form

Please complete your desired plaque inscription using the boxes below. Please note is a limit of 550 spaces with a maximum of 55 spaces on any line on a portrait plaque like the sample shown to the left. These 550 spaces must accommodate letters, blank spaces, and punctuation. A proof of your plaque will be provided for your approval prior to production.

Line 1	2	3	4	5	6	7	8	9	10	11	12	13	14	15	16	17	18	19	20	21	22	23	24	25
25	27	28	29	30	31	32	33	34	35	36	37	38	39	40	45	42	43	44	45	46	47	48	49	50
51	52	53	54	55	Line 2	2	3	4	5	6	7	8	9	10	11	12	13	14	15	16	17	18	19	20
21	22	23	24	25	26	27	28	29	30	31	32	33	34	35	36	37	38	39	40	41	42	43	44	45
46	47	48	49	50	51	52	53	54	55	Line 3	2	3	4	5	6	7	8	9	10	11	12	13	14	15
16	17	18	19	20	21	22	23	24	25	26	27	28	29	30	31	32	33	34	35	36	37	38	39	40
41	42	43	44	45	46	47	48	49	50	51	52	53	54	55	Line 5	2	3	4	5	6	7	8	9	10
11	12	13	14	15	16	17	18	19	20	21	22	23	24	25	26	27	28	29	30	31	32	33	34	35
36	37	38	39	40	41	42	43	44	45	46	47	48	49	50	51	52	53	54	55	Line 6	2	3	4	5
6	7	8	9	10	11	12	13	14	15	16	17	18	19	20	21	22	23	24	25	26	27	28	29	30
31	32	33	34	35	36	37	38	39	40	41	42	43	44	45	46	47	48	49	50	51	52	53	54	55
Line 7	2	3	4	5	6	7	8	9	10	11	12	13	14	15	16	17	18	19	20	21	22	23	24	25
25	27	28	29	30	31	32	33	34	35	36	37	38	39	40	45	42	43	44	45	46	47	48	49	50
51	52	53	54	55	Line 8	2	3	4	5	6	7	8	9	10	11	12	13	14	15	16	17	18	19	20
21	22	23	24	25	26	27	28	29	30	31	32	33	34	35	36	37	38	39	40	41	42	43	44	45
46	47	48	49	50	51	52	53	54	55	Line 9	2	3	4	5	6	7	8	9	10	11	12	13	14	15
16	17	18	19	20	21	22	23	24	25	26	27	28	29	30	31	32	33	34	35	36	37	38	39	40
41	42	43	44	45	46	47	48	49	50	51	52	53	54	55	Line 10	2	3	4	5	6	7	8	9	10
11	12	13	14	15	16	17	18	19	20	21	22	23	24	25	26	27	28	29	30	31	32	33	34	35
36	37	38	39	40	41	42	43	44	45	46	47	48	49	50	51	52	53	54	55	X	X	X	X	X

Name of Donor(s): _____

Please print name on line below exactly as it should appear at top of the room plaque.

Phone: _____ Email: _____



Pensacola State College
**YOUR COMMUNITY
YOUR LEGACY**

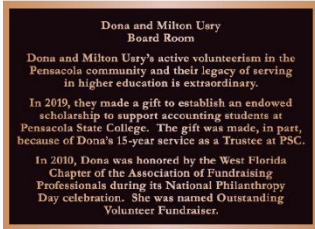

Visionary Donor Bronze Plaque Form

Please complete your desired plaque inscription using the boxes below. Please note is a limit of 440 spaces with a maximum of 55 spaces on any line on a plaque like the sample shown to the left. These 440 spaces must accommodate letters, blank spaces, and punctuation. A proof of your plaque will be provided for your approval prior to production.

Line 1	1	2	3	4	5	6	7	8	9	10	11	12	13	14	15	16	17	18	19	20	21	22	23	24	25
25	27	28	29	30	31	32	33	34	35	36	37	38	39	40	41	42	43	44	45	46	47	48	49	50	
51	52	53	54	55	Line 2	1	2	3	4	5	6	7	8	9	10	11	12	13	14	15	16	17	18	19	20
21	22	23	24	25	26	27	28	29	30	31	32	33	34	35	36	37	38	39	40	41	42	43	44	45	
46	47	48	49	50	51	52	53	54	55	Line 3	1	2	3	4	5	6	7	8	9	10	11	12	13	14	15
16	17	18	19	20	21	22	23	24	25	26	27	28	29	30	31	32	33	34	35	36	37	38	39	40	
41	42	43	44	45	46	47	48	49	50	51	52	53	54	55	Line 5	1	2	3	4	5	6	7	8	9	10
11	12	13	14	15	16	17	18	19	20	21	22	23	24	25	26	27	28	29	30	31	32	33	34	35	
36	37	38	39	40	41	42	43	44	45	46	47	48	49	50	51	52	53	54	55	Line 6	1	2	3	4	5
6	7	8	9	10	11	12	13	14	15	16	17	18	19	20	21	22	23	24	25	26	27	28	29	30	
31	32	33	34	35	36	37	38	39	40	41	42	43	44	45	46	47	48	49	50	51	52	53	54	55	
Line 7	1	2	3	4	5	6	7	8	9	10	11	12	13	14	15	16	17	18	19	20	21	22	23	24	25
25	27	28	29	30	31	32	33	34	35	36	37	38	39	40	41	42	43	44	45	46	47	48	49	50	
51	52	53	54	55	Line 8	1	2	3	4	5	6	7	8	9	10	11	12	13	14	15	16	17	18	19	20
21	22	23	24	25	26	27	28	29	30	31	32	33	34	35	36	37	38	39	40	41	42	43	44	45	
46	47	48	49	50	51	52	53	54	55	X	X	X	X	X	X	X	X	X	X	X	X	X	X	X	

Name of Donor(s): _____

Please print your name above exactly as you would like it to appear on the top of the room plaque.

Phone: _____ Email: _____

IN RECOGNITION

A group of distinguished individuals and business partners whose outstanding generosity demonstrates a commitment to the tradition of yesterday and the vision of tomorrow.

IN THE BEGINNING.....

Established in 1987, Oakton Community College opened its doors to 1,200 students in a single building. Over the years, the college has grown to become a premier institution of higher learning, and its success is a testament to the generosity of its donors.



The college's continued success and growth is a testament to the generosity of its donors. Their support has allowed the college to expand its facilities, improve its programs, and provide a world-class education for its students.



HERITAGE SOCIETY

1987-1988

1989-1990

1991-1992

1993-1994

1995-1996

1997-1998

1999-2000

2001-2002

2003-2004

2005-2006

2007-2008

2009-2010

2011-2012

2013-2014

2015-2016

2017-2018

2019-2020

2021-2022

2023-2024

2025-2026

2027-2028

2029-2030

2031-2032

2033-2034

2035-2036

2037-2038

2039-2040

2041-2042

2043-2044

2045-2046

2047-2048

2049-2050

2051-2052

2053-2054

2055-2056

2057-2058

2059-2060

2061-2062

2063-2064

2065-2066

2067-2068

2069-2070

2071-2072

2073-2074

2075-2076

2077-2078

2079-2080

2081-2082

2083-2084

2085-2086

2087-2088

2089-2090

2091-2092

2093-2094

2095-2096

2097-2098

2099-2100

2101-2102

2103-2104

2105-2106

2107-2108

2109-2110

2111-2112

2113-2114

2115-2116

2117-2118

2119-2120

2121-2122

2123-2124

2125-2126

2127-2128

2129-2130

2131-2132

2133-2134

2135-2136

2137-2138

2139-2140

2141-2142

2143-2144

2145-2146

2147-2148

2149-2150

2151-2152

2153-2154

2155-2156

2157-2158

2159-2160

2161-2162

2163-2164

2165-2166

2167-2168

2169-2170

2171-2172

2173-2174

2175-2176

2177-2178

2179-2180

2181-2182

2183-2184

2185-2186

2187-2188

2189-2190

2191-2192

2193-2194

2195-2196

2197-2198

2199-2200

2201-2202

2203-2204

2205-2206

2207-2208

2209-2210

2211-2212

2213-2214

2215-2216

2217-2218

2219-2220

2221-2222

2223-2224

2225-2226

2227-2228

2229-2230

2231-2232

2233-2234

2235-2236

2237-2238

2239-2240

2241-2242

2243-2244

2245-2246

2247-2248

2249-2250

2251-2252

2253-2254

2255-2256

2257-2258

2259-2260

2261-2262

2263-2264

2265-2266

2267-2268

2269-2270

2271-2272

2273-2274

2275-2276

2277-2278

2279-2280

2281-2282

2283-2284

2285-2286

2287-2288

2289-2290

2291-2292

2293-2294

2295-2296

2297-2298

2299-2300

2301-2302

2303-2304

2305-2306

2307-2308

2309-2310

2311-2312

2313-2314

2315-2316

2317-2318

2319-2320

2321-2322

2323-2324

2325-2326

2327-2328

2329-2330

2331-2332

2333-2334

2335-2336

2337-2338

2339-2340

2341-2342

2343-2344

2345-2346

2347-2348

2349-2350

2351-2352

2353-2354

2355-2356

2357-2358

2359-2360

2361-2362

2363-2364

2365-2366

2367-2368

2369-2370

2371-2372

2373-2374

2375-2376

2377-2378

2379-2380

2381-2382

2383-2384

2385-2386

2387-2388

2389-2390

2391-2392

2393-2394

2395-2396

2397-2398

2399-2400

2401-2402

2403-2404

2405-2406

2407-2408

2409-2410

2411-2412

2413-2414

2415-2416

2417-2418

2419-2420

2421-2422

2423-2424

2425-2426

2427-2428

2429-2430

2431-2432

2433-2434

2435-2436

2437-2438

2439-2440

2441-2442

2443-2444

2445-2446

2447-2448

2449-2450

2451-2452

2453-2454

2455-2456

2457-2458

2459-2460

2461-2462

2463-2464

2465-2466

2467-2468

2469-2470

2471-2472

2473-2474

2475-2476

2477-2478

2479-2480

2481-2482

2483-2484

2485-2486



Pensacola State College
**YOUR COMMUNITY
YOUR LEGACY**



Leader Donor Bronze Plaque Form

Please complete your desired plaque inscription using the boxes below. Please note is a limit of 330 spaces with a maximum of 55 spaces on any line on a cast bronze plaque like the sample shown to the left. These 330 spaces must accommodate letters, blank spaces, and punctuation. A proof of your plaque will be provided for your approval prior to production.

Line 1	2	3	4	5	6	7	8	9	10	11	12	13	14	15	16	17	18	19	20	21	22	23	24	25
25	27	28	29	30	31	32	33	34	35	36	37	38	39	40	45	42	43	44	45	46	47	48	49	50
51	52	53	54	55	Line 2	2	3	4	5	6	7	8	9	10	11	12	13	14	15	16	17	18	19	20
21	22	23	24	25	26	27	28	29	30	31	32	33	34	35	36	37	38	39	40	41	42	43	44	45
46	47	48	49	50	51	52	53	54	55	Line 3	2	3	4	5	6	7	8	9	10	11	12	13	14	15
16	17	18	19	20	21	22	23	24	25	26	27	28	29	30	31	32	33	34	35	36	37	38	39	40
41	42	43	44	45	46	47	48	49	50	51	52	53	54	55	Line 5	2	3	4	5	6	7	8	9	10
11	12	13	14	15	16	17	18	19	20	21	22	23	24	25	26	27	28	29	30	31	32	33	34	35
36	37	38	39	40	41	42	43	44	45	46	47	48	49	50	51	52	53	54	55	Line 6	2	3	4	5
6	7	8	9	10	11	12	13	14	15	16	17	18	19	20	21	22	23	24	25	26	27	28	29	30
31	32	33	34	35	36	37	38	39	40	41	42	43	44	45	46	47	48	49	50	51	52	53	54	55
X	X	X	X	X	X	X	X	X	X	X	X	X	X	X	X	X	X	X	X	X	X	X	X	X

Name of Donor(s): _____

Please print your name above exactly as you would like it to appear on the top of the room plaque.

Phone: _____ Email: _____



Sustainer Donor Bronze Plaque Form

Please complete your desired plaque inscription using the boxes below. Please note is a limit of 165 spaces with a maximum of 55 spaces on any line on a cast bronze plaque like the sample shown to the left. These 165 spaces must accommodate letters, blank spaces, and punctuation. A proof of your plaque will be provided for your approval prior to production.

Line 1 1	2	3	4	5	6	7	8	9	10	11	12	13	14	15	16	17	18	19	20	21	22	23	24	25
25	27	28	29	30	31	32	33	34	35	36	37	38	39	40	41	42	43	44	45	46	47	48	49	50
51	52	53	54	55	Line 2 1	2	3	4	5	6	7	8	9	10	11	12	13	14	15	16	17	18	19	20
21	22	23	24	25	26	27	28	29	30	31	32	33	34	35	36	37	38	39	40	41	42	43	44	45
46	47	48	49	50	51	52	53	54	55	Line 3 1	2	3	4	5	6	7	8	9	10	11	12	13	14	15
16	17	18	19	20	21	22	23	24	25	26	27	28	29	30	31	32	33	34	35	36	37	38	39	40
41	42	43	44	45	46	47	48	49	50	51	52	53	54	55	X	X	X	X	X	X	X	X	X	X

Name of Donor(s): _____

Please print your name above exactly as you would like it to appear on the top of the room plaque.

Phone: _____ Email: _____

1
A-110
1/8" = 1'-0"

Ground Floor 360 SEATS

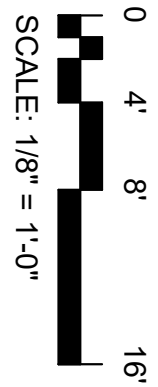
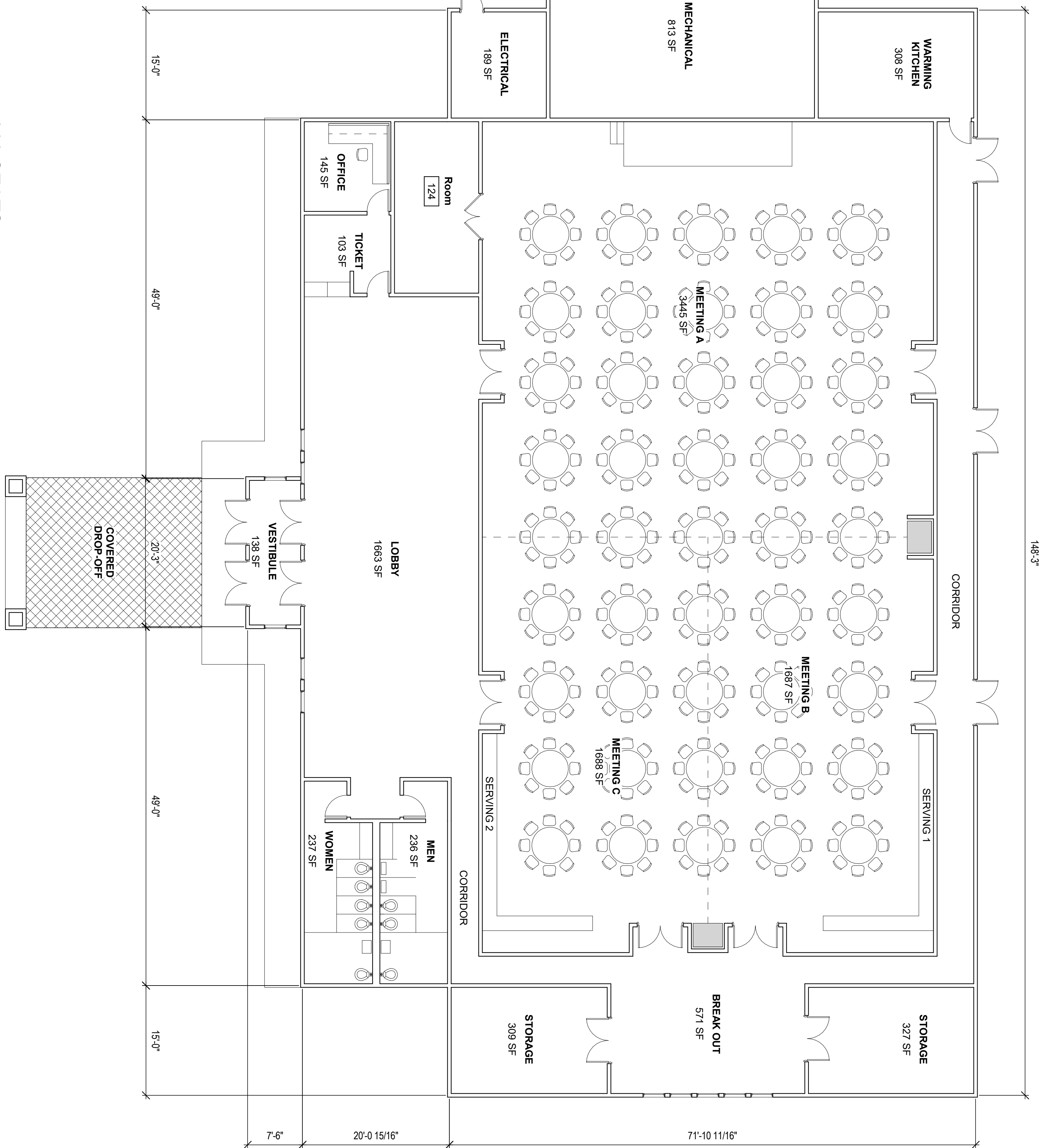

SCALE: 1/8" = 1'-0"

Conceptual Floor Plan

SHEET:
A-110

BUILDING PLAN

BTA PROJECT NO. BTA 6.3018
SHEET DATE: 09/28/2019

Pensacola State College Conference Center Concept

Pensacola State College Main Campus

SIGNATURE AND SEAL

REVISIONS:

909 East Cervantes
Pensacola, FL 32501
AAC000174
www.bullocktice.com
Fax: 850.432.5208
Phone: 850.434.5444

